

# CAVIUS™

**SMART**   
REMOTE

**WIRELESS**   
ALARM FAMILY

PLEASE READ THIS USER GUIDE CAREFULLY

# CAVIUS™

## WIRELESS SMART REMOTE

Model Number: 9002-001

Developed by CAVIUS™

The Smart Remote is designed to work in conjunction with CAVIUS™ Wireless Family Alarms. When a Wireless Family Alarm detects smoke or fire, the Wireless Smart Remote will flash and vibrate for instant warning. The torch function can be used to find escape routes at night.

---

**PLEASE READ THE USER GUIDE  
CAREFULLY BEFORE INSTALLATION  
AND RETAIN FOR FUTURE USE.**

---

## CONTENTS

1. Technical information	4
2. How to connect to the Wireless Alarm Family	6
3. Installation	10
4. Test of alarms	12
5. Alarm mode	13
6. The Cavius™ Wireless Alarm Family has two different alarm signals	14
7. Alarm silence	14
8. Torch	17
9. Low battery signal	17
10. Batteries replacement	18
11. Maintenance & troubleshooting	18
12. Warranty	22

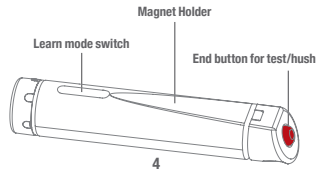
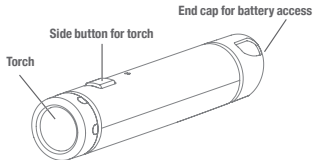

### TECHNICAL INFORMATION:

The Smart Remote can be used with both the CAVIUS™ Wireless Alarm Family Smoke, and Thermal Heat Alarm. The maximum number of alarms the remote can interlink with is 32.

Wireless Alarms and Smart Remote have a 100m+ connection range. Be sure to test your alarms after installation as RF conditions may depend on house layouts and materials.

Diameter: 27mm  
Length: 140mm

The Smart Remote is powered by 3 replaceable Duracell or Panasonic AAA Alkaline batteries. Please note for correct operation of the Smart Remote device, the use of Duracell or Panasonic batteries are required.

Interlinked by RF: 926.365 MHz

Complies to standards: RoHS, REACH, R&TTE, EN60065, EN300-220. 5

## HOW TO CONNECT SMART REMOTE WITH WIRELESS FAMILY ALARMS:

**1.** Open the end of the remote, insert batteries, then close.

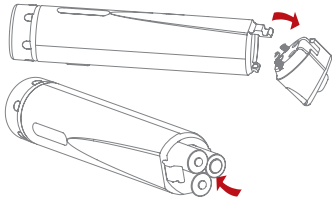

6

**2.** Slide the switch on the remote to “Learn mode”.  
Do this on all other Wireless alarms also.

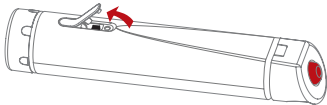

Normal Mode

Learn Mode

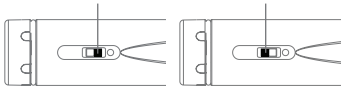

7

**3.** The torch on the remote will light up to indicate that “Learn mode” has been selected.

**4.** Press and hold the test button on the Smart Remote. It will sound a sharp beep while flashing. Once this happens, the remote then becomes the ‘master’ and will send out a unique code to all the other Wireless Alarms that are in ‘learn mode’.

**5.** As the other alarms receive the unique code, they will also start to flash (red lights).

**6.** Once all Wireless alarms are flashing they have been successfully connected. The remote and all Wireless Alarms can now be turned back to ‘normal mode’ by flicking the switch back to its original position. Alarms will then stop flashing and will be ready to be installed.



## INSTALLATION:

The body of the Smart Remote has a built-in magnet, allowing it to be placed on a fridge, or other metal surfaces. The metal plate included with the remote can be installed to a surface by using the screws included. The end cap of the remote has a hole in which a lanyard can be added so the remote can hang from a hook.

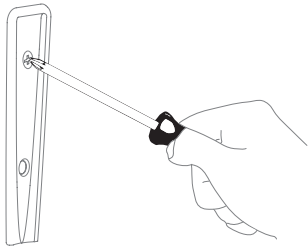

### **TEST OF ALARMS:**

After installation, and at least once per quarter, test all your alarms by pressing the test button on the remote to ensure they are operating correctly and are within range of each other.

It is recommended to check visually every week if the LED flashes correctly on the alarm (every 48sec.).

Hold the red end button for two swipes of alarms until the remote stops flashing, sounding and vibrating.

The remote is now transmitting a test signal to your alarms. During the test, the Smart Remote will flash and sound.

If the Smart Remote is receiving a test signal from another device, it will also flash and sound to indicate that it is part of the group. Indication can be stopped by pressing the end button.

### **ALARM MODE:**

When one of the connected alarms is going into alarm and sending out the RF alarm signal, the Smart Remote's flashlight will start flashing rapidly (stroboscope).

The Smart remote has a built in vibrator and sounder which will follow the sound pattern of the originating alarm. During the alarm, both the sounder and vibrator will be activated.

The torch can be switched from stroboscopic flashing to constant on by pressing the side button.

## KNOW THE SOUND OF YOUR ALARM:

**CAVIUS™** Wireless alarms have one alarm sound which will alert you to life threatening situations such as smoke and/or heat.

Please note that only the originating alarm's LED will flash, so you can identify the source of the fire.

Alarm signal 1 (--- --- ---) is life threatening alarms, like a smoke alarm.

Alarm signal 2 (- - -) is a non life threatening alarm, like a flooding alarm:

Smoke alarm signal:            --- --- ---

Heat alarm signal:            --- --- ---

Please note that only the originating alarm's LED will flash, so it can be identified.

## ALARM SILENCE:

When the alarms from the Wireless Alarm Family go into alarm, they can be hushed by a short press on the end button of the Smart Remote.

- During the first 30 seconds of an alarm: Press the red end button once and the remote stops sounding and vibrating, LED is still flashing.

The remote is now waiting to send out the hush signal which will start automatically within 30 seconds.

- After 30 seconds of an alarm:

Press the red end button once and the remote will send out a hush signal for 13 seconds. If needed to hush several alarms, this can be repeated as many times as necessary.

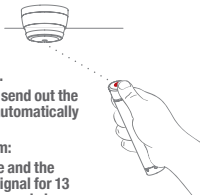



**Please note:** Due to coming legislation, the hush signal is transmitted with reduced power (the remote must be within short range from the silenced alarm, which means you should be in the same room as the alarm).

You can hush any of your alarms in the system, as long as you are in the same room and within short range of the alarm.

**IMPORTANT NOTE:** in order to silence all your Wireless alarms immediately, the alarm that has to be turned off first is the alarm that originally sensed the smoke or fire (and will be flashing). This silencing can be done by pushing the hush button or using the Smart Remote. If you silence an alarm other than the source of the alarm, the remaining alarms will still sound.

The Smart Remote can only stop the alarmed device after 30 seconds in alarm mode. The reason for this is to make sure you have identified the source of the fire before using the hush function.

#### **TORCH:**

The torch can be turned on and off by pressing the side button. Please note: The light will turn off automatically after 5 minutes.

#### **LOW BATTERY SIGNAL:**

30 days before the battery is due to die, a short beep will start to sound every 48 seconds.

Only the device affected by the low battery will beep, no other connected devices will sound.

It is safe to change batteries in the Smart Remote without going through the learn process again – it will not forget the codes during the battery change process.

### **BATTERIES REPLACEMENT:**

Access the 3 x AAA batteries by removing the end cap of the Smart Remote.

After replacing batteries, be sure to test the Smart Remote to ensure you have placed them in the right way and the remote is functioning. Dispose of used batteries according to local environmental regulations.

**Note:** Please ensure the correct and recommended type of battery is used for replacement.

### **BATTERY MAINTENANCE:**

If the Smart Remote does not work when the test/Hush button is pushed, the probable cause is faulty batteries which must be replaced.

Please email [info@cavius.co.nz](mailto:info@cavius.co.nz) if you experience any issues regarding your Smart Remote.

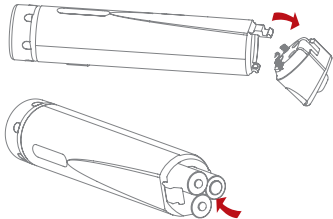

The CE mark affixed to this product confirms its compliance with the European Directives which apply to the product.



All Rights reserved: CAVIUS Aps assumes no responsibility for any errors, which may appear in this manual. Furthermore, CAVIUS Aps reserves the right to alter the hardware, software, and/or specifications detailed herein at any time without notice, and CAVIUS Aps does not make any commitment to update the information contained herein. All the trademarks listed herein are owned by their respective owners. Copyright © CAVIUS Aps.

Manufactured by:

**CAVIUS** Aps

Julsøvej 16 - DK8600 Silkeborg.

[www.cavius.com](http://www.cavius.com) - [info@cavius.com](mailto:info@cavius.com)

Manufactured in P.R.C.

**Distributor information:**

---

CAVIUS Nano Ltd. 2G Ashley Place, Papamoa,  
Bay Of Plenty 3118.

P.O Box 11241, Palm Beach Plaza, Papamoa,  
Bay Of Plenty 3151, New Zealand.

[www.cavius.co.nz](http://www.cavius.co.nz) - Hotline: 0800 766533  
or 07 542 2191

---

REP ELEC.

Locked Bag 45, Plumpton, NSW 2761, Australia.

[www.cavius.com.au](http://www.cavius.com.au) - PH: 1300 555 586

**WARRANTY:**

Your **CAVIUS™** Wireless Family Smart Remote has a 1 year warranty from the date of purchase against defect in material and workmanship. Faulty units during this period can be returned to the place of purchase. You must provide the proof of purchase date and such defects will be repaired, or replaced at the distributors option, without charge. This Warranty only covers defects in materials or workmanship in normal residential use and does not cover damage resulting from negligent handling, misuse or lack of reasonable care. This warranty is in lieu of any other warranty either expressed or implied.

**MODEL NUMBER:****9002-001****PRODUCT CODE:****CAVSR**

# CAVIUS™

**SMART**  **REMOTE**

**WIRELESS**   
ALARM FAMILY

PLEASE READ THIS USER GUIDE CAREFULLY